

SITE MAP LOCATION

**LEGEND:**

APPLICATION SITE BOUNDARY	
LANDS IN APPLICANT'S CONTROL	
EXISTING RIGHT OF WAY / WAYLEAVE	
Proposed 4m Wide Access Path For Details Refer to Dwg. A1045-CSE-HEL-XX-DR-C-2031	
220 kV GRID ROUTE:	
PROPOSED 220 kV UG CIRCUIT 1 GUNNOCKS TO WOODLAND	
PROPOSED 220 kV UG CIRCUIT 2 GUNNOCKS TO CORDUFF	
PROPOSED 8m JOINT BAYS	
GROUND LEVEL	
EXISTING SERVICES	
EXISTING ESB	
EXISTING ESB OVERHEAD	
EXISTING GAS	
EXISTING TELECOMS	
EXISTING FOUL	
EXISTING WATERMAIN	

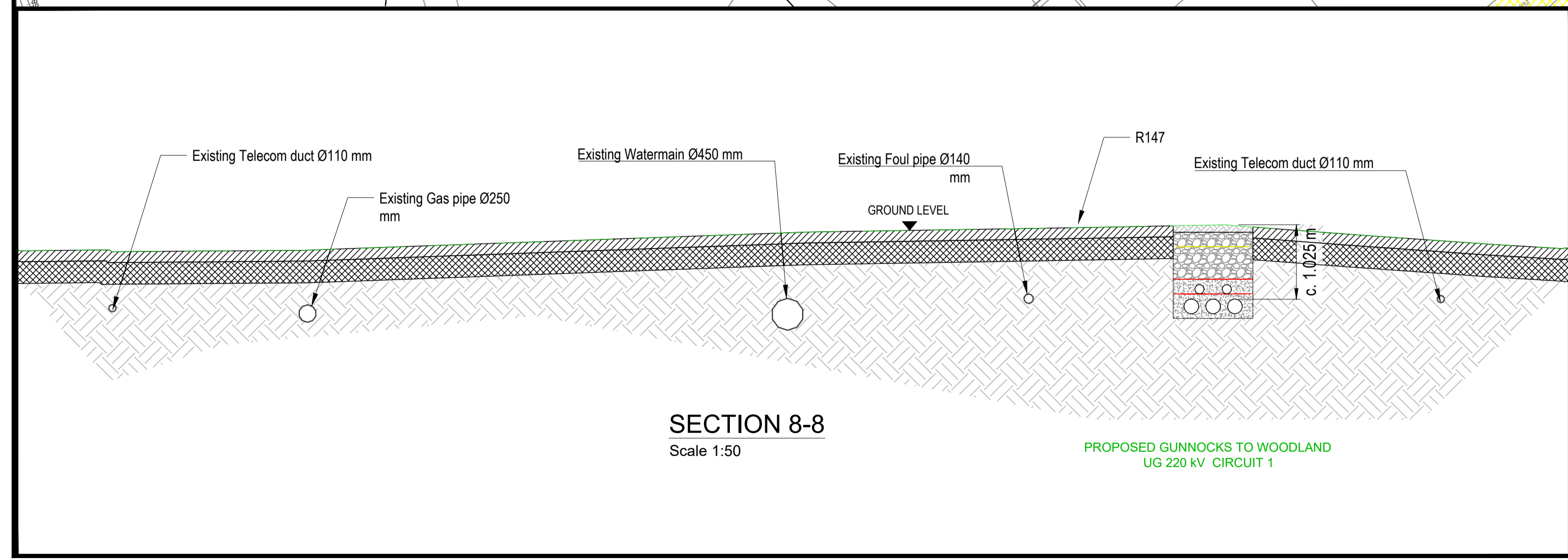
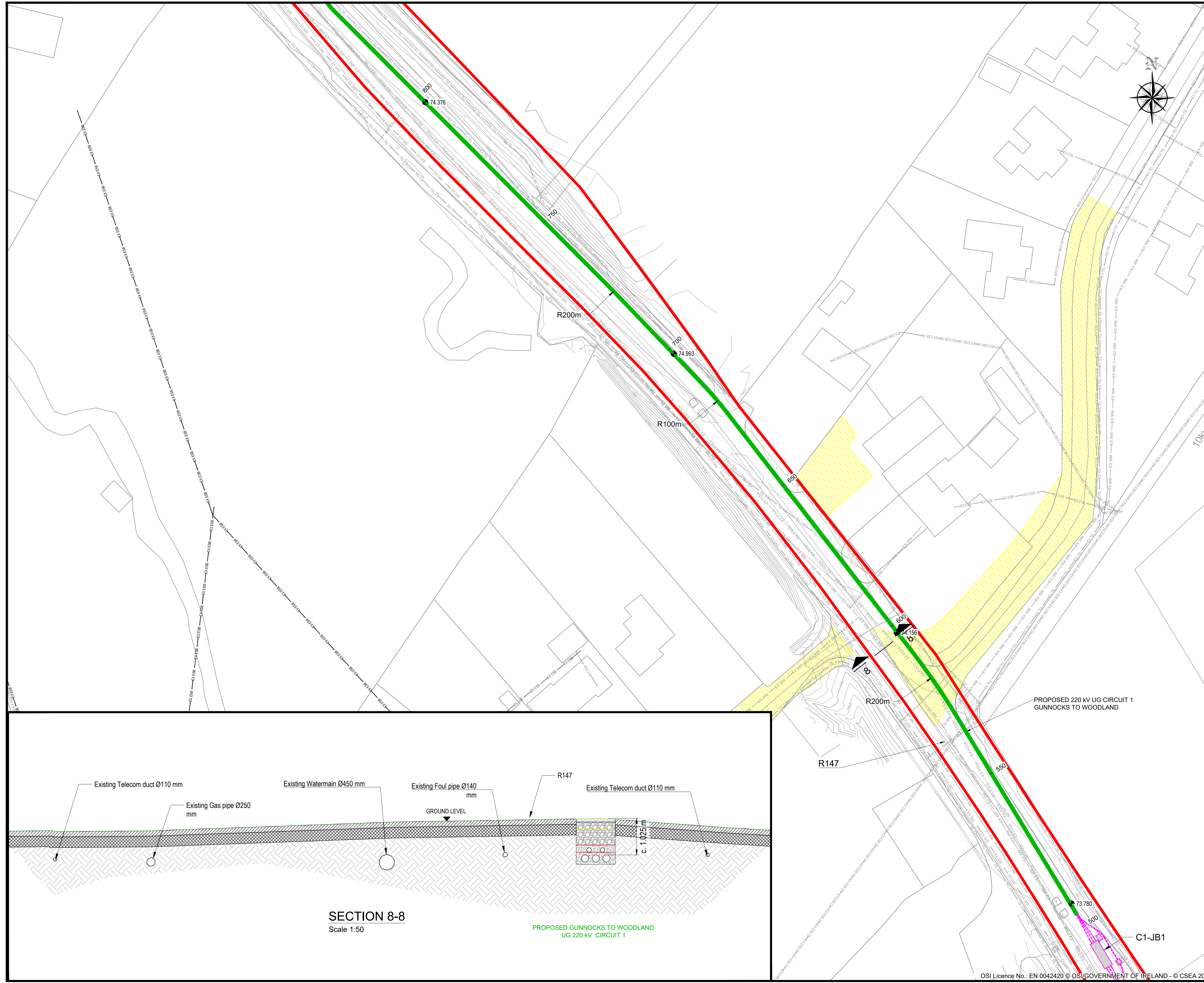

P02	ISSUE FOR PLANNING	ZS	CD	30/07/2020
P01	DRAFT FOR PLANNING	ZS	CD	17/07/2020
Rev	Description	Drawn	Checked	Date

**Clifton Scannell Emerson Associates**  
Clifton Scannell Emerson Associates Limited  
Consulting Engineers,  
Seafor Lodge,  
Castledawson Avenue,  
Blackrock, Co. Dublin,  
Ireland, A94 P768  
T: +353 1 288 5006  
F: +353 1 283 3466  
E: info@csea.ie  
W: www.csea.ie

Client	ENGINE NODE			
Project	ENGINE NODE 220 KV SUBSTATION AND GRID CONNECTION			
Dwg. Title	PROPOSED 220 KV ROUTE LAYOUT PLAN & SECTION SH 8 OF 13			
Drawn By	PH	Date	23-04-2020	18_086
Checked By	CD	Scale	1:500 @ A1	CSEA Job No.
Project Code	Originator	Zone/Phase	Level	Type
A1045 - CSE - HEL - XX - DR - C - 2018				
S2	FOR INFORMATION			
Status Code	Suitability Description			
P02	PLANNING			
Revision	Project Status			